

FOR REFERENCE: FROM PROJECT CH-2353 PAGE 1 PROJECT

**FIREPROOFING CLARIFICATIONS:**

- ALL COLLUMS IN BUILDING "A" REQUIRE FIREPROOFING AS PER U.L. DESIGNS (EXCEPTION: COLLUMS AT STAGE DO NOT REQUIRE FIREPROOFING)
- ALL FLOORING AND ROOF CEILING DETAILS IN BUILDING "A" ARE REQUIRED TO BE FIREPROOFED AS PER U.L. DESIGNS.

**PARTITION LEGEND:**

- INDICATES 4 HR SEPERATION.
- INDICATES 2 HR FIRE RATED PARTITION CONSTRUCTED OF 8" METAL STUDS @ 16" O.C. WITH TWO (2) LAYERS OF 5/8" TYPE "X" Gypsum BOARD EACH SIDE. EXTEND WALL TO UNDERSIDE OF ROCK WOOL @ 8" - 11" BATT.
- INDICATES 1 HR FIRE RATED PARTITION CONSTRUCTED OF 2-5/8" 25 GA. METAL STUDS @ 16" O.C. WITH ONE (1) LAYER OF 5/8" TYPE "X" Gypsum BOARD BOTH FACES PARTITION SHALL EXTEND UP AND BE SEALED TO UNDERSIDE OF CEILING AT FIRST FLOOR. EXTEND WALL TO SECONDARY CEILING ON SECOND FLOOR. SEE DETAIL 17A-B, U.L. DESIGN 419 SHEET A-2.
- INDICATES SOUND WALL - CONSTRUCTED OF 2-5/8" METAL STUDS @ 16" O.C. WITH 2-1/2" FIBERGLASS BATT'S BETWEEN STUDS WITH 5/8" Gypsum BOARD EACH SIDE. METAL STUDS @ 16" O.C. WITH BATT INSULATION WHERE INDICATED. EXTEND WALL TO UNDER SIDE OF ROCK WOOL.
- INDICATES WALLS, PORTIONS OF WALLS, MILLWORK, FLOORING, ETC TO BE REMOVED.

**GENERAL NOTES:**

- ALL DIMENSIONS OF INTERIOR PARTITIONS SHALL BE TO FACE OF STUD AND NOT CENTERLINE OF COLUMN UNLESS NOTED OTHERWISE.
- ALL 16" METAL STUDS SHALL BE 25 GA. SPACED 16" O.C. UNLESS NOTED OTHERWISE. 8" METAL STUDS SHALL BE 18 GA. SPACED 16" O.C.
- CONTRACTOR SHALL PROVIDE TWO (2) METAL STUDS AT EACH JAMB OF H.W. FINISH.
- ALL NON-RATED PARTITIONS SHALL EXTEND A MIN. OF 6" ABOVE SCHEDULE CEILING HEIGHT & BRACE TO INTERSECTING WALLS @ 45 DEGREE.
- ALL BUILT-IN SHELVING SHALL BE ADJUSTABLE WITH COATED EDGES BENDED.
- ALL WOOD USED IN PERMANENT CONSTRUCTION OF WALLS, FLOORS & CEILINGS (E.T.C.) SHALL BE OF FIRE RETARDANT TREATED LUMBER AT INTERIOR & EXTERIOR EXPOSURE.
- FIBERGLASS WALLEBOARD PANELS SHALL BE USED IN LIEU OF Gypsum BOARD SHEATHING IN ALL EXPOSED CHANGING ROOM WALL AREAS. 1/2" THICK FIBERGLASS SHALL BE USED IN LIEU OF 5/8" Gypsum BOARD ON FACE OF TRACK #1 ON 2ND FLOOR LEVEL (NOT INSIDE WALKING CORRIDOR WALLS - SEE DETAIL 5/1-16) WHILE 5/8" FIBERGLASS WALLEBOARD SHALL BE USED ON FIRST FLOOR WALL AREAS.
- PROVIDE 4" BATT INSULATION ABOVE ALL ADDITIONAL LAT-IN CEILING ON FIRST AND SECOND FLOORS IN BUILDING "B" AND WHERE REQUIRED FOR U.L. DESIGNS IN BUILDING "A" (SEE SHEET A-2)

DRAWN: LWC

CHECKED: JLC

DESIGN PROCESS DATE: 03.08.18

FINAL DATE: 03.27.18

REVISION SCHEDULE: REV # / REV DATE: 00.00.00

LANDRY LEWIS GERMANY, PLLC  
 30300 HUNTER LANE, SUITE 100  
 HATTIESBURG, MISSISSIPPI 39235

PROJECT: RENOVATIONS TO CAC - CHRISTIAN ACTIVITIES CENTER TEMPLE BAPTIST CHURCH HATTIESBURG, MISSISSIPPI

SHEET #15  
 FIRST FLOOR PLAN

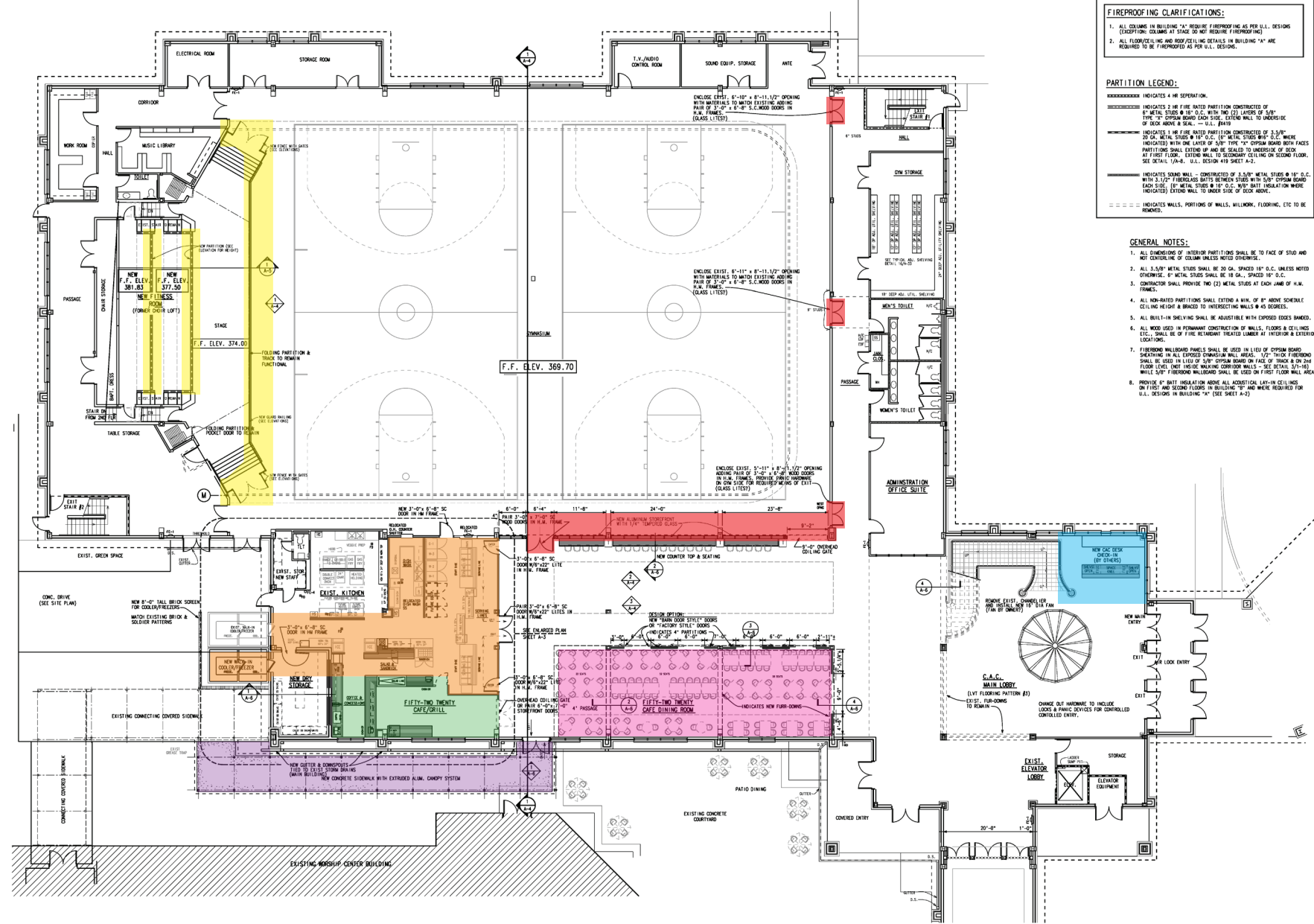

- Enlarge kitchen to encompass the current serving area and the width of the dining area.
- Provide space for the café within the kitchen area.
- Configure current dining area to allow for semi-permanent seating.
- Reroute traffic from the north gym entrance to a new side door.
- Reconfigure current stage to allow for cardio equipment and limit access (a current safety issue).
- Remove current reception desk and move to a smaller desk by exterior doors.
- Wall in the gym to limit access.



# First Floor

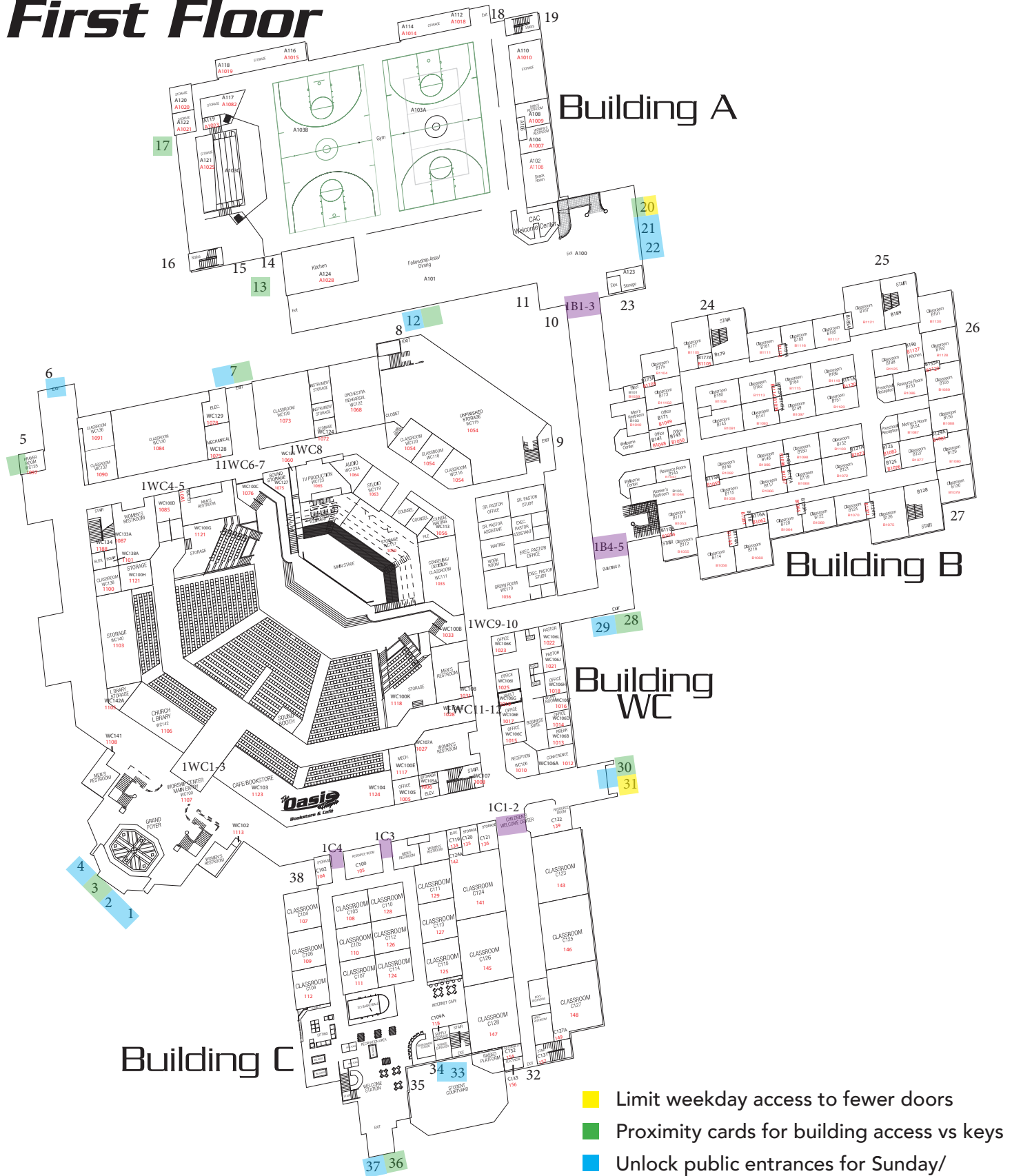

Building A

Building B

Building WC

Building C

- Limit weekday access to fewer doors
- Proximity cards for building access vs keys
- Unlock public entrances for Sunday/Wednesday and events
- Create interior lockdown zones for
  - Building B (Preschool)
  - Building C (Children and Youth)